

Section 19

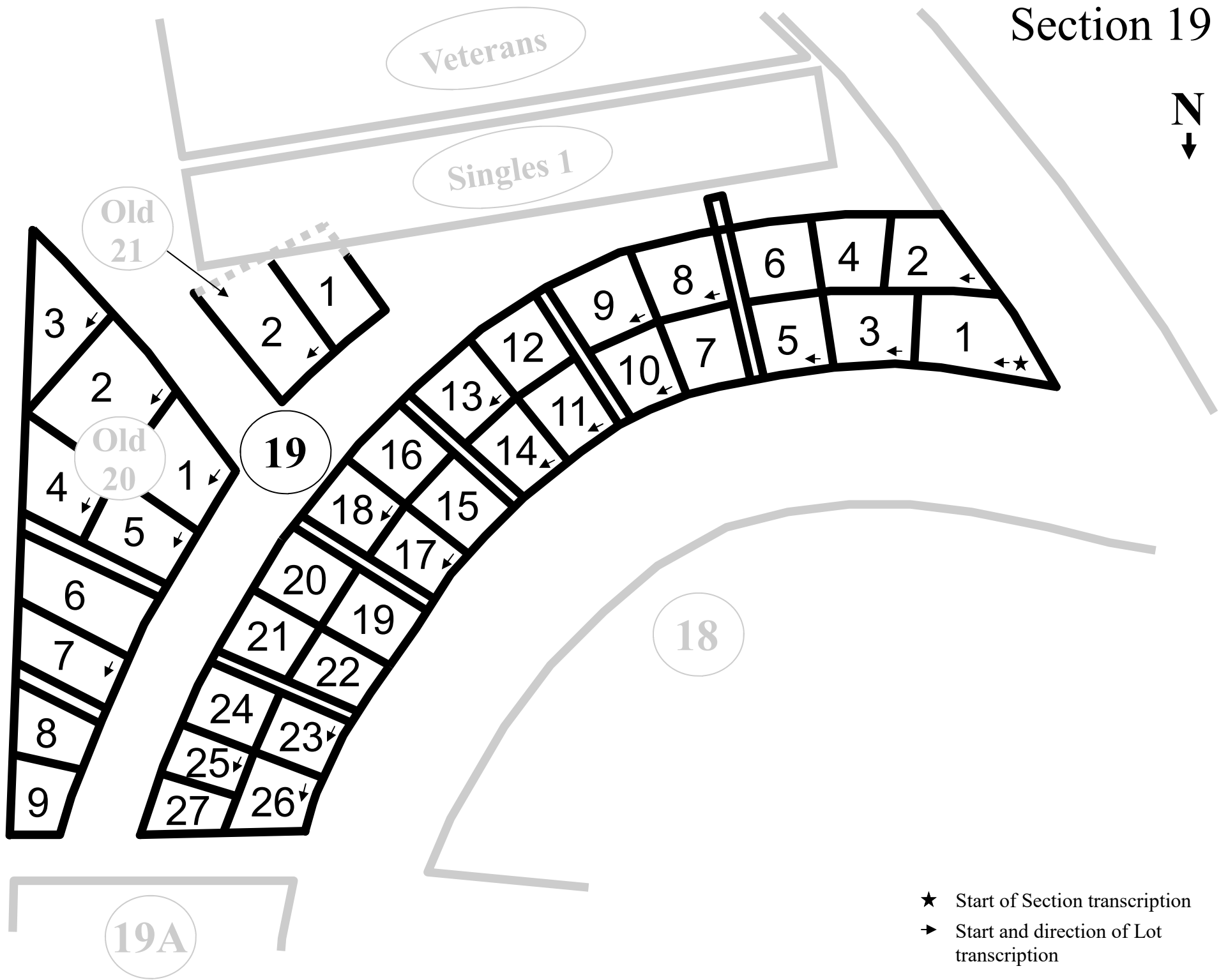

Section 19

Lot 1

SCHRONCE	Bobbie Lee	1931 - 1989 (d. July 6, 1989 in Northville)
SCHRONCE	Joyce Catherine WICK	1932 - 2014 (d. Mar. 31, 2014)

"Our Children Michael, David, Nancy, Carla"

Lot 3

Row 1

GIBSON	Elsie <i>Bertha</i> WICK	1896 - 1990 (d. Jan. 21, 1990 in Osceola Co., FL)
WICK	Herman C.	"Son", 1894 - 1963 (d. Jan. 18, 1963 in Osceola Co., FL)
WICK	Christian	"Father", 1858 - 1930 (d. Jan. 28, 1930 in Farmington, Oakland Co., MI)
WICK	Bertha WITT	"Mother", 1871 - 1897 (d. July 18, 1897 in Novi, Oakland Co., MI)

Row 2

WICK	William	1893 - 1982 (d. Dec. 11, 1982 in Baldwin, Lake Co., MI)
WICK	Fred W.	"Husband", 1900 - 1988 (d. July 14, 1988 in Farmington Hills, Oakland Co., MI)
WICK	Agnes M. HENNING	"Wife" 1909 - 1998 (d. Aug. 16, 1998)

Lots 5 & 7

Row 1

SMITH	Clarence A.	1913 - 1918 (d. Feb. 24, 1918 in Northville)
SMITH	Millie M. ROLLET	"Mother", 1875 - 1931 (d. Sept. 12, 1931 in Northville)
SMITH	William W.	"Father", 1882 - 1957 (d. Feb. 18, 1957 in Northville)
SMITH	Mary SHOEBRIDGE (<i>nee</i> TRAUB)	1886 - 1951 (d. June 16, 1951 in Northville)

Row 2

SMITH	<i>Violet Virginia</i> May	"Baby Girl", 1944 (d. June 8, 1944 in Northville)
PERKINS	Baby Girl	1951
STANFORD	Baby Boy	1962 (d. July 23, 1962 in Livonia, Wayne Co., MI)
SMITH	Richard T.	1907 - 1974 (d. May 25, 1974 in Northville)
SMITH	Ann M. DELONEY	1909 - 1989 (d. June 7, 1989 in Howell, Livingston Co., MI as Agatha SMITH)

Lot 10

Row 1

MACFARLANE	Jimmy	"Married 62 Years", June 15, 1918 - Jan. 25, 2008
MACFARLANE	Lily NEWMAN	Jan. 17, 1920 - Aug. 23, 2002

Row 2

DUSHA	Herbert E.	Odd Fellows, "Father", 1888 - 1927 (d. Sept. 21, 1927 in Ann Arbor, MI)
MACFARLANE	Jim (<i>James</i>)	Apr. 16, 1947 - Nov. 26, 1997

Lot 11

CLARK	George	No Dates (d. Sept 1966 at age 77 as George CLARKE; doi 9/28/1966)
	Baby	No Dates

Section 19

Lot 14

COLLINS	Roger A.	1870 - 1926 (d. Dec. 3, 1926 in Northville)
FOX	Ruth M. <i>SAMSEN</i>	"Mother", 1900 - 1969 (d. Dec. 30, 1969 in Northville; b. as Ruth M. SAGE)
FOX	infant	"d/o Walter & Ruth FOX", No Dates (doi 10/12/1923)
FOX	Walter	Pvt. U.S. Army, WW I, Nov. 18, 1892 - Nov. 19, 1989 (d. in Northfield Twp, Washtenaw Co., MI)

Lot 15

No Markers

Lot 17

PEARL	Marvin	1906 - 1910 (d. Nov. 12, 1910 in Northville)
JOHNSON	Esther	"w/o Marion", 1862 - 1924 (d. Oct. 21, 1924 in Novi Twp, Oakland Co., MI)
JOHNSON	Frank	"Infant s/o F. N. & E. M.", 1926

Easement between Lots 17 & 19

GRIFFIN	Annie MOORE	"Mother", 1888 - 1940 (d. Apr. 20, 1940 in Eloise, Wayne Co., MI)
---------	-------------	---

Lot 19

JARRAIT	Mary Adline RENAUD	No Marker (d. June 6, 1887 in Northville at age 33)
JARRAIT	Lucy	No Marker (d. June 13, 1887 in Northville at age 0)
JARRAIT	Mary	No Marker (d. June 14, 1887 in Northville at age 0)

Lot 22

No Markers

Lot 23

LANG	Robert	1878 - 1941 (d. June 21, 1941 in Northville)
------	--------	--

Lot 26

MARVIN	<i>William</i>	Co. E., 5th Mich. Inf. (d. Oct. 25, 1912 in Northville at age 77)
--------	----------------	---

Lot 2

KILLEEN	Alvin B.	WW II, USAAF, 8th Air Force 452nd Bomb Group, B-17's, "Husband, Father, Grandfather", "Married July 10, 1945", June 7, 1924 - July 5, 2011
KILLEEN	Marja C. <i>HATCHETT</i>	"Wife, Mother, Grandmother", Jan. 15, 1928 - Dec. 2, 2009
ROSSELLE	Pamphile <i>Joseph</i>	Pfc U.S. Army, Korea, Apr. 8, 1932 - Mar. 8, 1996 (d. in Allen Park, Wayne Co., MI)

Lot 4

No Markers

Lot 6

No Markers

Section 19

Easement between Lots 6 & 8

FISHER	Elmer	1906 - 1926 (d. June 8, 1926 in Northville)
FISHER	James	1869 - 1935 (d. May 28, 1935 in Warren Twp, Macomb Co., MI)

Lot 8

HUNTER	Lyla May <i>GLAESNER</i>	"Mother", 1890 - 1980 (d. Oct. 20, 1980 in LaGrange, IN)
HUNTER	Wilfred J.	"Father", 1874 - 1931 (d. Mar. 25, 1931 in Northville)

Lot 9

NESTER	Edward W.	"Our Boy", 1922 - 1929 (d. Jan. 2, 1929 in Northville)
McCLINTOCK	<i>James William</i>	1888 - 1929 (d. Aug. 28, 1929 in Northville)

Lot 12

No Markers

Lot 13

SCHWARTZ	Pauline <i>GRENKE</i>	1878 - 1941 (d. Nov. 19, 1941 in Novi, Oakland Co., MI)
SCHWARTZ	Frank A.	1879 - 1937 (d. July 8, 1937 in Novi Twp, Oakland Co., MI)
GILES	Alida	"Baby", Oct. 25, 1936 (d. in Northville)
HOLLIS	James	1865 - 1928 (d. June 20, 1928 in Northville) (back of GILES; see Sec 25)

Lot 16

No Markers

Lot 18

GAINES	John N.	1925 - 1929 (d. Sept. 20, 1929 in Northville)
DeRUBIES	Lino	1904 - 1924 (d. July 21, 1924 in Northville)
BONTA	Cora <i>HAGAR</i>	1859 - 1933 (d. Apr. 23, 1933 in Novi Twp, Oakland Co., MI)

Lot 20

unknown	child-sized cement grave frame
---------	--------------------------------

Lot 21

No Markers

Lot 24

No Markers

Lot 25

unknown	unknown	"Father", No Dates
GIBBS	Robert <i>Taylor</i>	1877 - 1904 (d. Oct. 22, 1894 in Wayne Co., MI, per BATC)
GIBBS	Mary J. <i>BRAND</i>	1835 - 1908 (d. Aug. 13, 1908 in Eloise, Wayne Co., MI)
unknown		loose "J. M. N." footstone

Section 19

Lot 27

No Markers

Old Sec 21, Lot 1

No Markers

Old Sec 21, Lot 2

BOLTON	Clarence Leroy	1914 - 1985 (d. Aug. 13, 1985 in Tarpon Springs, Pinellas Co., FL)
BOLTON	Rose May <i>BEDORE</i>	1916 - 1972 (d. Mar. 31, 1972 in Wayne, Wayne Co., MI)

Easement between Old Sec 21, Lot 2 and Old Sec 20, Lot 1

BOLTON	Michael	"Our Baby", Apr. 10, 1946 - July 7, 1946 (d. in Northville)
BOLTON	Marlene E.	"Our Baby", 1935 - 1937 (d. Apr. 7, 1937 in Northville)
EISNER	Ira <i>Whitman</i>	May 30, 1877 - Mar. 30, 1933 (d. in Ann Arbor, MI)

Old Sec 20, Lot 1 South

Row 1

WADSWORTH	Harry	1880 - 1933 (d. Mar. 12, 1933 in Northville)
-----------	-------	--

Row 2

TIBBITS	Wylie <i>Duane</i>	1877 - 1943 (d. Jan. 28, 1943 in Northville)
NEWTON	James Alexander	1860 - 1937 (d. Feb. 5, 1937 in Northville)

Old Sec 20, Lot 1 North

SULKOWSKI	Oscar H.	1899 - 1964 (d. Feb. 18, 1964 in Eloise, Wayne Co., MI)
SULKOWSKI	Oscar H., Jr.	No Marker (d. June 27, 1939 in Superior Twp, Washtenaw Co., MI at age 17)
SULKOWSKI	Ida BLAKE	No Marker (d. Aug. 17, 1988 in Farmington Hills, Oakland Co., MI at age 84)

Old Sec 20, Lot 5

SCHARCHBURG	Lizzie <i>SCHRIBER</i>	1861 - 1938 (d. Feb. 6, 1938 in Eloise, Wayne Co., MI)
SCHARCHBURG	William	"Father", 1876 - 1958 (d. Sept. 10, 1958 in Northville)
SCHARCHBURG	Maud R. <i>SOBER</i>	"Mother", 1882 - 1955 (d. Dec. 7, 1955 in Northville)
SCHARCHBURG	Harvey E.	"Son", 1909 - 1956 (d. Mar. 31, 1956 in Northville)

Old Sec 20, Lot 6

No Markers

Old Sec 20, Lot 7

JOHNSON	Elizabeth	1875 - 1887
---------	-----------	-------------

Old Sec 20, Lot 8

No Markers

Old Sec 20, Lot 9

No Markers

Section 19

Old Sec 20, Lot 2

ROBBINS	Mary Rose <i>MILES</i>	1865 - 1945 (d. July 10, 1945 in Northville)
ROBBINS	Myron <i>Jeheil</i>	1856 - 1942 (d. June 8, 1942 in Northville)
ROBBINS	Milo E.	1890 - 1940 (d. Jan. 8, 1940 in Northville)

Old Sec 20, Lot 4

Row 1

BROWN	Frank L.	1873 - 1939 (d. Dec. 22, 1939 in Eloise, Wayne Co., MI)
BROWN	Retta <i>BOVEE</i>	1861 - 1943 (d. Mar. 21, 1943 in Eloise, Wayne Co., MI)

Row 2

MUNOZ	Fred	1918 - 1943 (d. Oct. 20, 1943 in Northville)
MUNOZ	Petra	1922 - 1945 (d. Oct. 5, 1945 in Detroit)

HERMAN	John George	1879 - 1943 (d. Oct. 14, 1943 in Eloise, Wayne Co., MI)
--------	-------------	---

Old Sec 20, Lot 3

Row 1

SMITH	Richard W.	"Father", 1907 - 1943 (d. Nov. 4, 1943 in Northville)
-------	------------	---

Row 2 (overgrown at edge of woods)

HOLMAN	Kaye F.	Aug. 13 - Nov. 22, 1941 (d. in Northville)
--------	---------	--

SCHMITZ	Judy Kay	"d/o Wm & Eulala", Aug. 15, 1944 (d. in Northville at age 0)
---------	----------	--

REMBOWSKI	Jan Robert	Mar. 22, 1943 (d. in Northville at age 0)
-----------	------------	---

OSBORNE	Hane A.	"Infant Son", 1943 - 1943 (d. Jan. 25, 1943 in Northville)
---------	---------	--