

5

Section 7

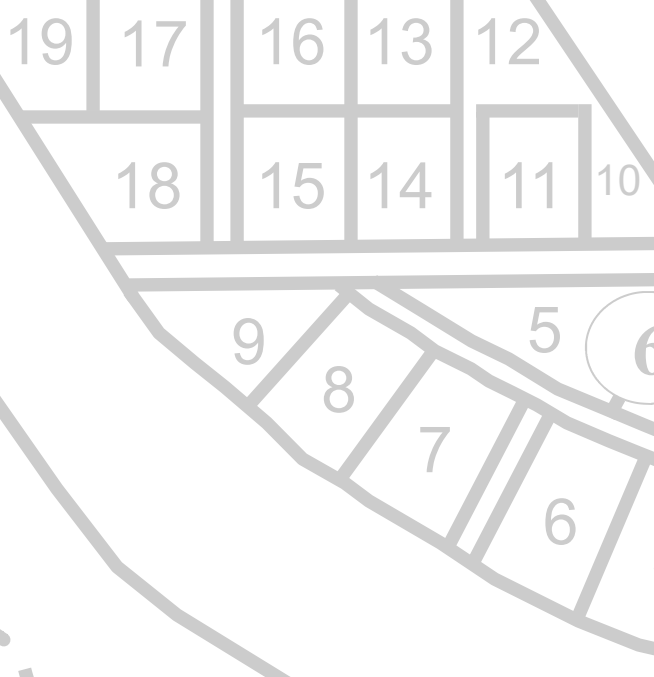
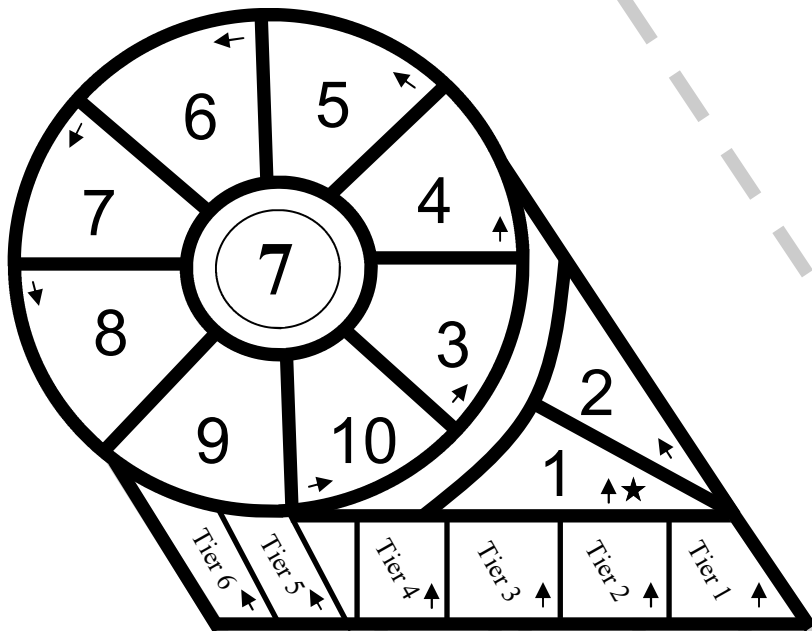

5

5

- ★ Start of Section transcription
- ➔ Start and direction of Lot/Tier transcription

Section 7
Family Lots

	FAMILY	ACQUIRED BY	DATE
Lot 1	Yerkes	Wm P. Yerkes	Dec. 29, 1896
Lot 2	Olds	W. G. Lapham	Apr. 17, 1896
Lots 3 to 10	Lapham	J. S. Lapham	May 19, 1886 ¹

¹ purchase recorded as 1886, but in chronological order for 1887

Section 7

Lot 1

YERKES YERKES	Sallie E. CADY Wm. Purdy	"His Wife", May 16, 1833 - Dec. 22, 1896 (d. in Northville) Oct. 23, 1820 - Nov. 20, 1902 (d. in Northville)
------------------	-----------------------------	---

Lot 2

OLDS	Moses A.	1815 - 1896 (d. Apr. 13, 1896 in Plymouth)
LESTER LESTER LESTER	Judith Kay Virginia Ruth PRICE Eber Ward	Nov. 20, 1944 - July 26, 1945 (d. in Spartanburg, SC) No Marker (d. Sept. 12, 2011 in GA at age 91) No Marker (d. Dec. 31, 2004 in GA at age 84)
PORRITT	Mark Henry	1923 - 1946 (d. Sept. 29, 1946 in Eloise, Wayne Co., MI)
PRICE	George I.	Mason, "Father", 1892 - 1960 (d. Mar. 1, 1960 in Livonia, Wayne Co., MI)
PRICE	Maude R. SIMS	Eastern Star, "Mother", 1891 - 1968 (d. Nov. 20, 1968 in Farmington, Oakland Co., MI)
ADAMOV ADAMOV	Michael Milly CVETANOVICH	June 8, 1921 - July 17, 1978 (d. in Livonia, Wayne Co., MI) Sept. 20, 1923 - Apr. 13, 2020 (d. in Farmington, Oakland Co., MI)

Lot 3

CADY CADY DOWD	Lucinda KNAPP Helen L. Lucy LOCKWOOD	Feb. 2, 1812 - Feb. 12, 1903 (d. in Northville) Nov. 11, 1855 - May 13, 1892 (d. in Windsor, Ontario, Canada) Aug. 12, 1835 - Mar. 5, 1914 (d. in Northville; 1st husband was William C. STOUT)
----------------------	--	---

Lot 4

FISKE LAPHAM	Mary GREGORY Martha GREGORY	Nov. 23, 1829 - Jan. 27, 1890 (d. in Bonne Terre, MO) "w/o J. S. Lapham", Nov. 23, 1829 - May 18, 1887 (d. in Anamosa, Jones Co., Iowa)
-----------------	--------------------------------	--

Lot 5

LAPHAM LAPHAM LAPHAM LAPHAM	Jared S. Jared S. William G. Edith C. S. STOUT	Feb. 4, 1822 - Jan. 10, 1893 (d. in Plymouth Twp) Apr. 18, 1886 - Nov. 24, 1929 (d. in Northville) Sept. 28, 1855 - Oct. 18, 1925 (d. in Northville) "w/o William", 1855 - 1940 (d. Feb. 27, 1941 in Charlottesville, VA)
LAPHAM monument		"In memory of Jared S. & Martha Gregory, his wife."

Lot 6

ORPHAN ORPHAN	Andrew G. Faith A. LIEBETREU	1920 - 1988 (d. July 28, 1988 in Lee Co., FL) 1922 - 2010 (d. Aug. 22, 2010)
------------------	---------------------------------	---

Section 7

Lot 7

Row 1

LIEBETREU	Ella A. <i>STERN</i>	1892 - 1989 (d. Mar. 13, 1989 in Northville)
LIEBETREU	William A.	1883 - 1958 (d. Mar. 23, 1958 in Northville)

Row 2

WILCOX	Charles Lonson	Jan. 20, 1900 - Oct. 11, 1956 (d. in Northville)
--------	----------------	--

Lot 8

PERKINS	Peter L.	1898 - 1979 (d. Nov. 15, 1979 in Westland, Wayne Co., MI)
PERKINS	Thelma R. <i>BENNETT</i>	1898 - 1947 (d. Feb. 28, 1947 in Northville)

KLEINERT	Richard Hayes	1929 - 2002 (d. May 21, 2002 in Oakland Co., MI)
KLEINERT	Aneta A. <i>FRY</i>	1903 - 1963 (d. June 6, 1963 in Detroit)
KLEINERT	Herbert H.	1898 - 1960 (d. Jan. 5, 1960)

Lot 9

No Markers

Lot 10

BOVEE	Elie A.	July 1849 - Jan. 22, 1917 (d. in Ypsilanti, Washtenaw Co., MI)
BOVEE	Jennie <i>CADY</i>	Jan. 23, 1851 - Sept. 23, 1913 (d. in Ypsilanti, Washtenaw Co., MI)

Tier 1

SEGREST	Kenneth W.	1906 - 1976 (d. Apr. 24, 1976 in Livonia, Wayne Co., MI)
---------	------------	--

NILES	Archie Sr.	"Father", Mar. 19, 1889 - Dec. 11, 1975 (d. in Livonia, Wayne Co., MI)
NILES	Rose <i>FONTENEAU</i>	"Mother", May 9, 1895 - Sept. 29, 1979 (d. in Northville)

Tier 2

KUMMER	William J.	1896 - 1971 (d. Apr. 23, 1971 in Fort Lauderdale, FL)
KUMMER	Mary Adelia <i>THEISEN</i>	1896 - 1971 (d. Jan. 14, 1971 in Northville)

GOW	Sumner <i>Charles</i>	Sept. 5, 1920 - May 6, 1971 (d. in Oakland Co., MI)
GOW	Janice	No Marker (d. Nov. 28, 1990 in Ann Arbor, MI at age 45)

Tier 3

WESTOVER	Jay <i>Allen</i>	1908 - 1971 (d. May 26, 1971 in Madison Heights, Oakland Co., MI)
WESTOVER	Grace H. <i>McKAY</i>	1889 - 1977 (d. May 7, 1977 in Dothan, AL)

HONEY	James H.	1898 - 1975 (d. Sept. 15, 1975 in Michigan)
HONEY	Edith A. <i>WYERS</i>	1899 - 1975 (d. Dec. 18, 1975 in Plymouth)

Tier 4

JACKSON	Effie <i>MATHERS</i>	1899 - 1984 (d. Dec. 30, 1984 in Farmington Hills, Oakland Co., MI)
JACKSON	Marion	1895 - 1969 (d. July 24, 1969 in Eloise, Wayne Co., MI)

SMITH	Alfred B.	"Husband", 1898 - 1962 (d. Oct. 28, 1962 in Pontiac, MI)
-------	-----------	--

Section 7

Tier 5

COOLMAN	Robert <i>Franklin</i>	Mason, Dec. 16, 1901 - Oct. 9, 1969 (d. in Livonia, Wayne Co., MI)
COOLMAN	Marjorie H. HORAN	No Marker (d. Nov. 19, 1995 in Redford Twp, Wayne Co., MI at age 87)
RICHARDS	Elmer M.	Mason, 1914 - 1970 (d. Feb. 26, 1970)
RICHARDS	Ermal Eva <i>STAFFORD</i>	Eastern Star, 1921 - 2002 (d. June 3, 2002)
HOLLIS	Mary Belle	"Aunt", Sept. 6, 1924 - Nov. 3, 1999 (d. in Westerville, OH)
HOLLIS	Maude STARR	Eastern Star, "Mother", July 31, 1894 - Aug. 14, 1968 (d. in Northville)
ROSE	Ruby PRODGER (<i>nee</i> <i>DIAMOND</i>)	"Mother", Oct. 4, 1902 - June 20, 1960 (d. in Detroit; 1st husband was Arthur PRODGER)

Tier 6

PARKER	Joseph Chandler	1891 - 1942 (d. Feb. 5, 1942 in Ann Arbor, MI)
PARKER	Anna DEACON	1892 - 1939 (d. June 20, 1939 in Northville)
ELWELL	<i>Jenny</i> Elizabeth STARR-ARNDT	1901 - 1995 (d. Apr. 4, 1995 in Los Angeles Co., CA)
ELWELL	Oren Ernest	1898 - 1966 (d. July 6, 1966 in Northville)
STARR	George <i>Byron</i>	Mason, 1863 - 1952 (d. May 27, 1952 in Greenbush Twp, Clinton Co., MI)
STARR	Ida May <i>McCULLY</i>	1867 - 1944 (d. Mar. 18, 1944 in Northville)
BIERSCHBACH	Jacob <i>Peter</i>	Mich. Pvt. 1Cl. 128 Inf. 32 Div., Nov. 23, 1894 - July 2, 1945 (d. in Livonia, Wayne Co., MI)
BOWEIN	Louis H.	No Marker (d. Dec. 29, 1973 in Highland Park, Wayne Co., MI at age 70)